

Manuel métallerie
BatchBlock B28_CD
Cheminée à droite

Licence CC-BY-SA 4.0
UZUME.fr

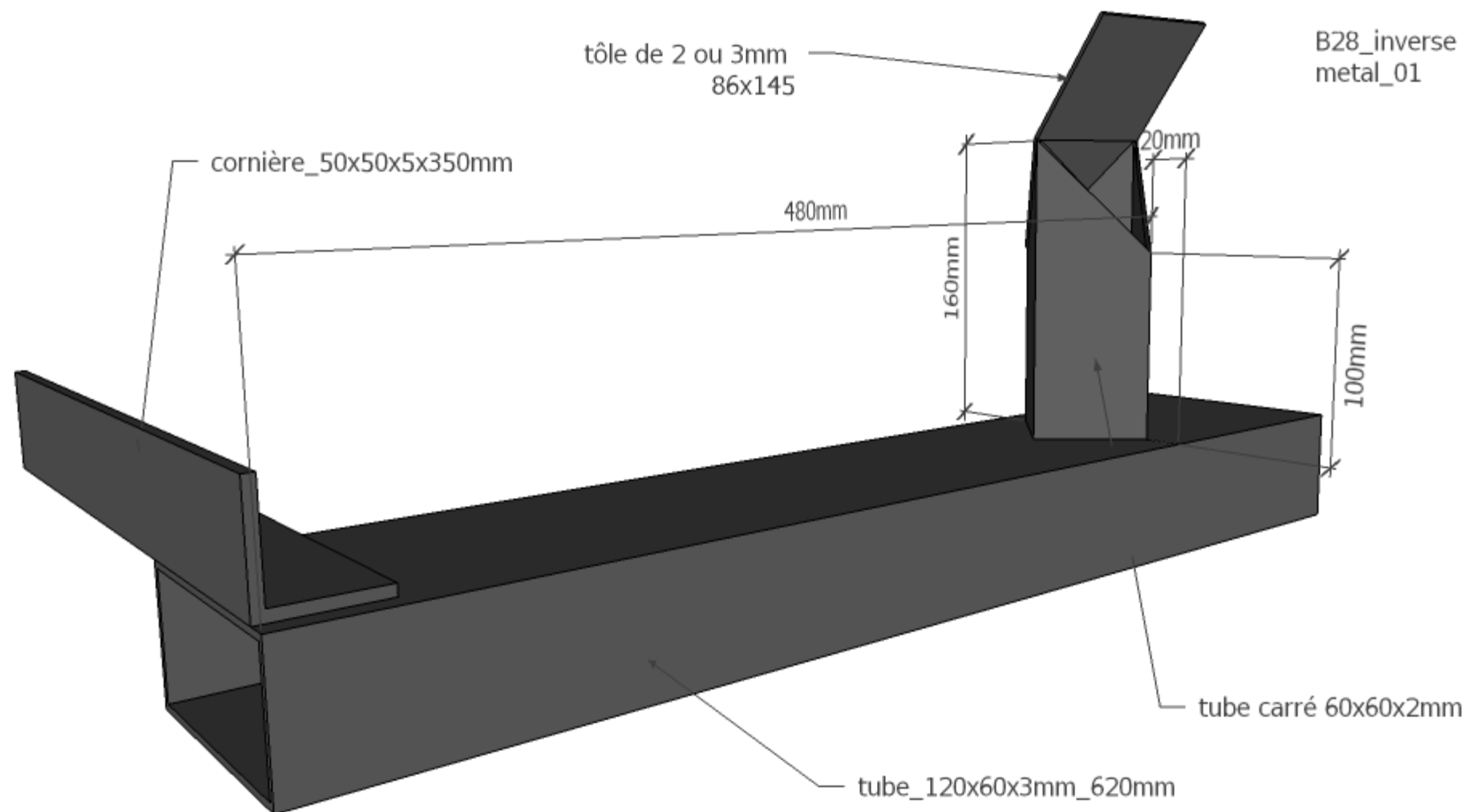

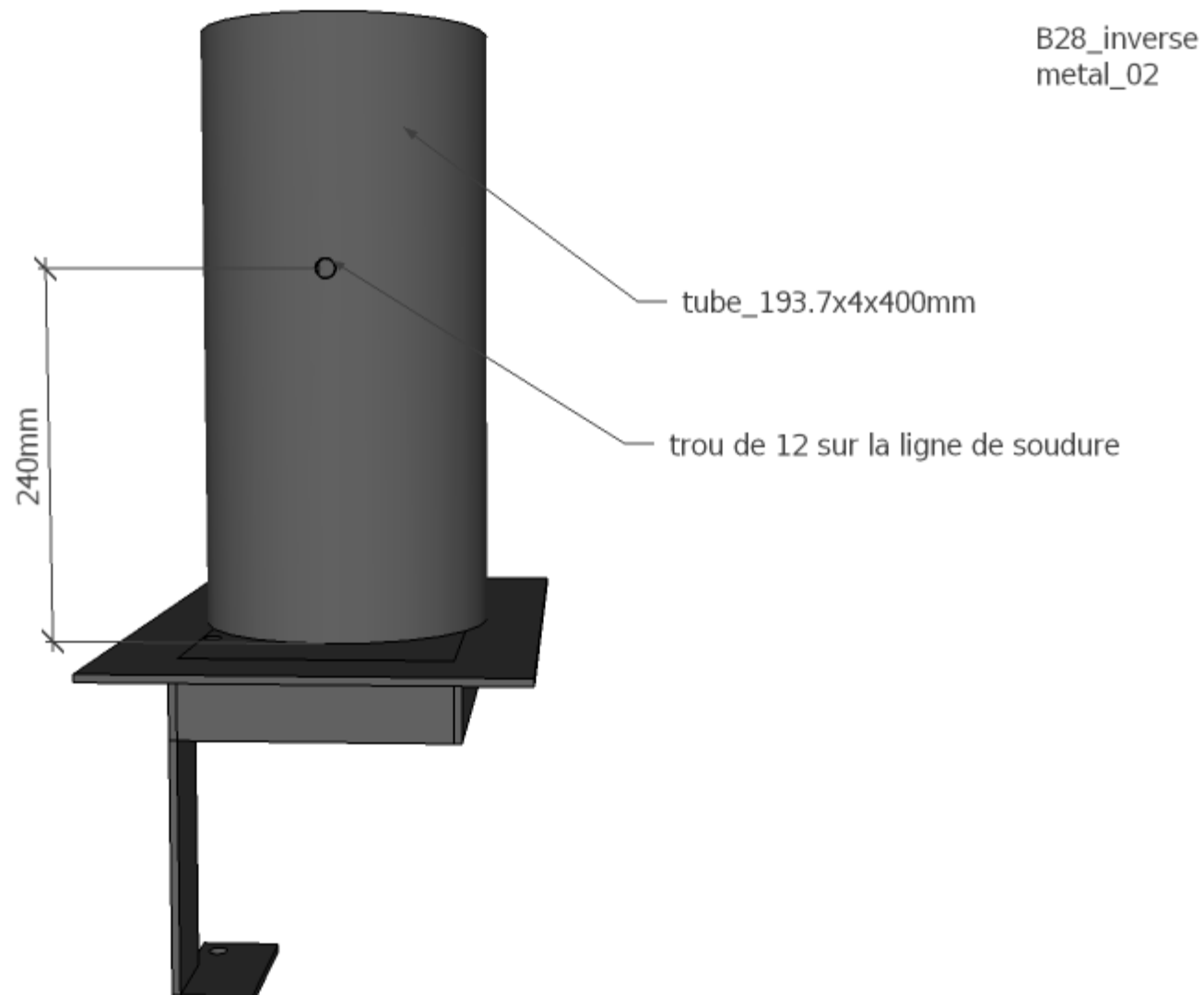

B28_inverse
metal_03

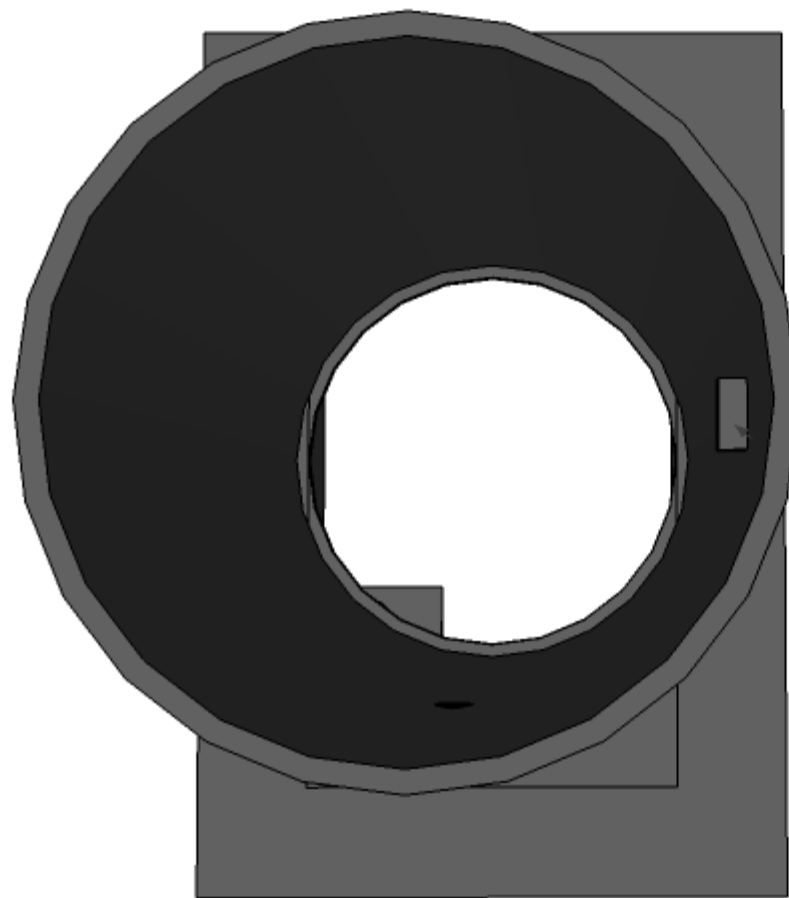

fer_carre_8mmx20mm
soudé à 60mm du bord du tube

B28_inverse
metal_04

cornière 50x50x5

trou de 12mm

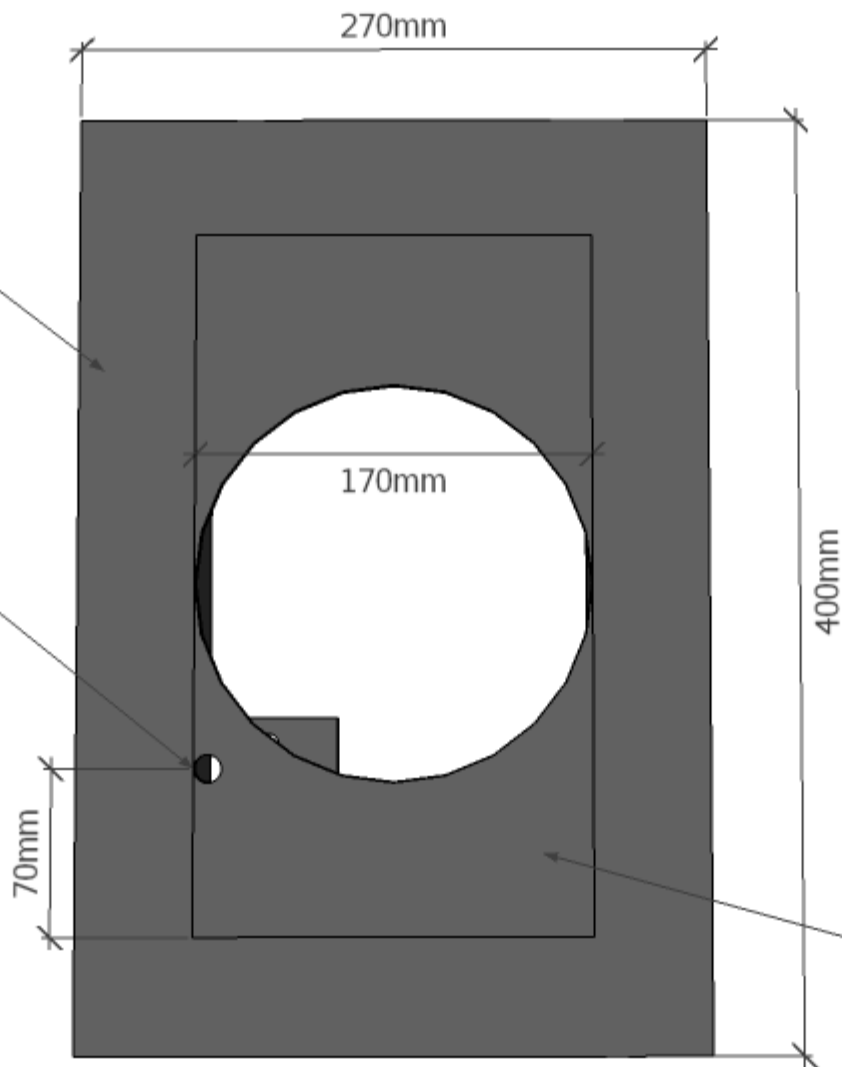

tôle 3 ou 5mm

B28_inverse
metal_05

fer_plat_160x50x5mm

fer_plat_090x50x5mm_perce à 12
Le centre du trou à 13 des deux bords

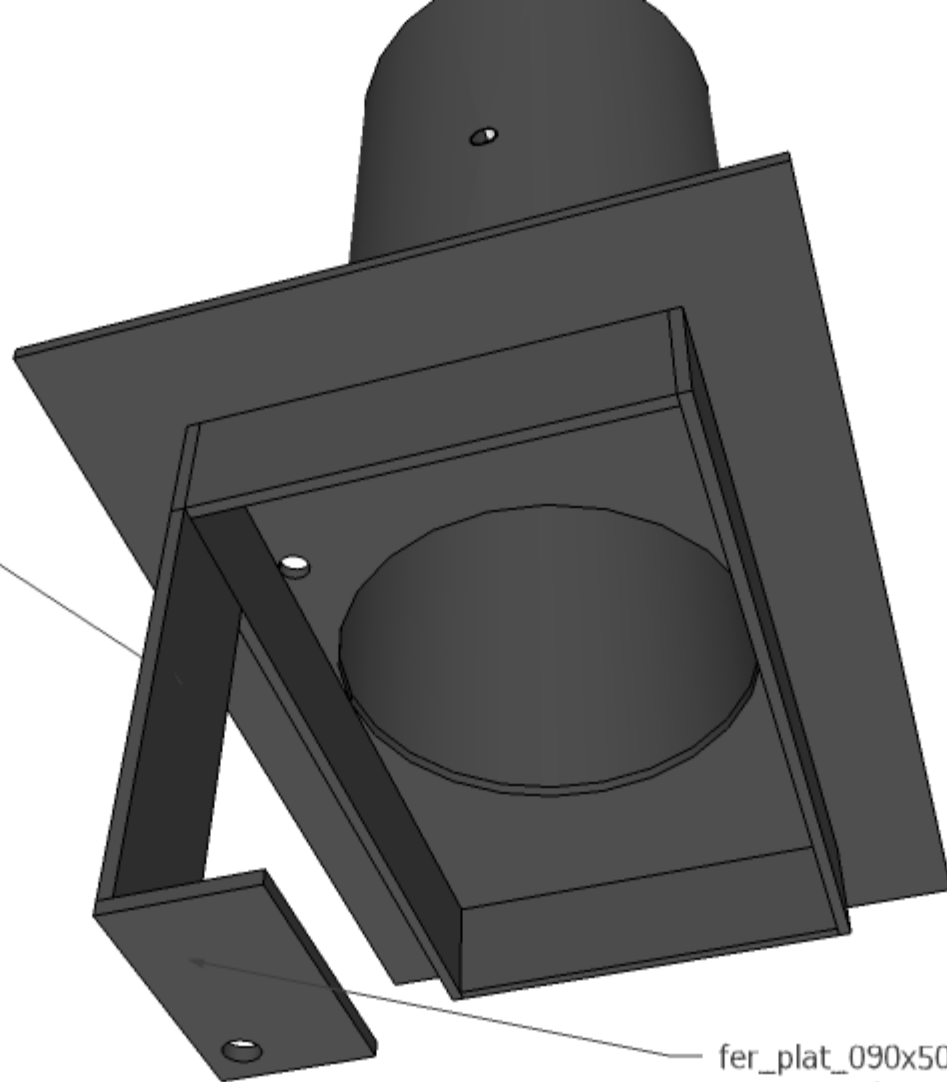

B28_inverse
metal_06

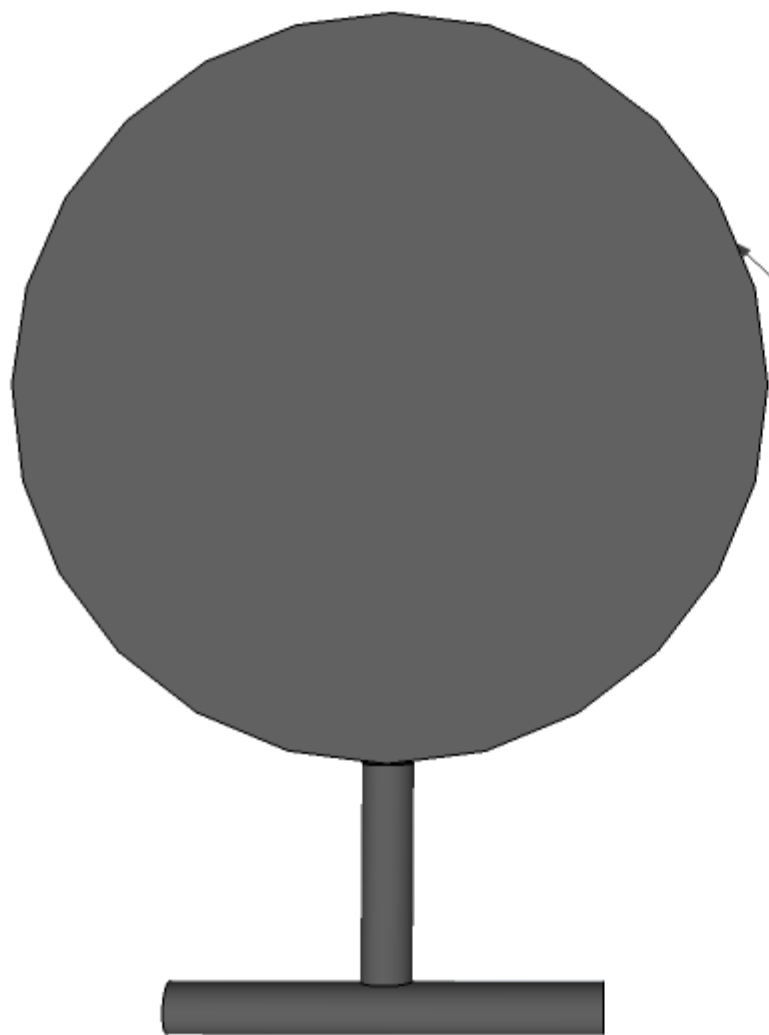

disque_176x5mm

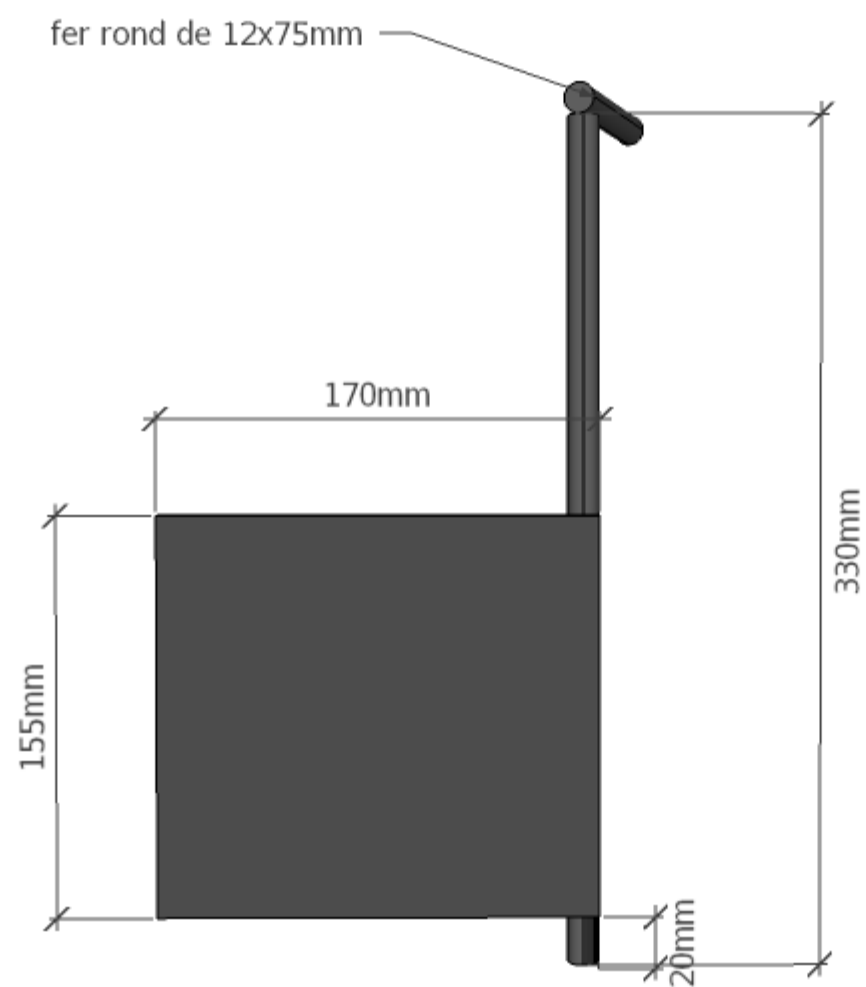

B28_inverse
metal_07

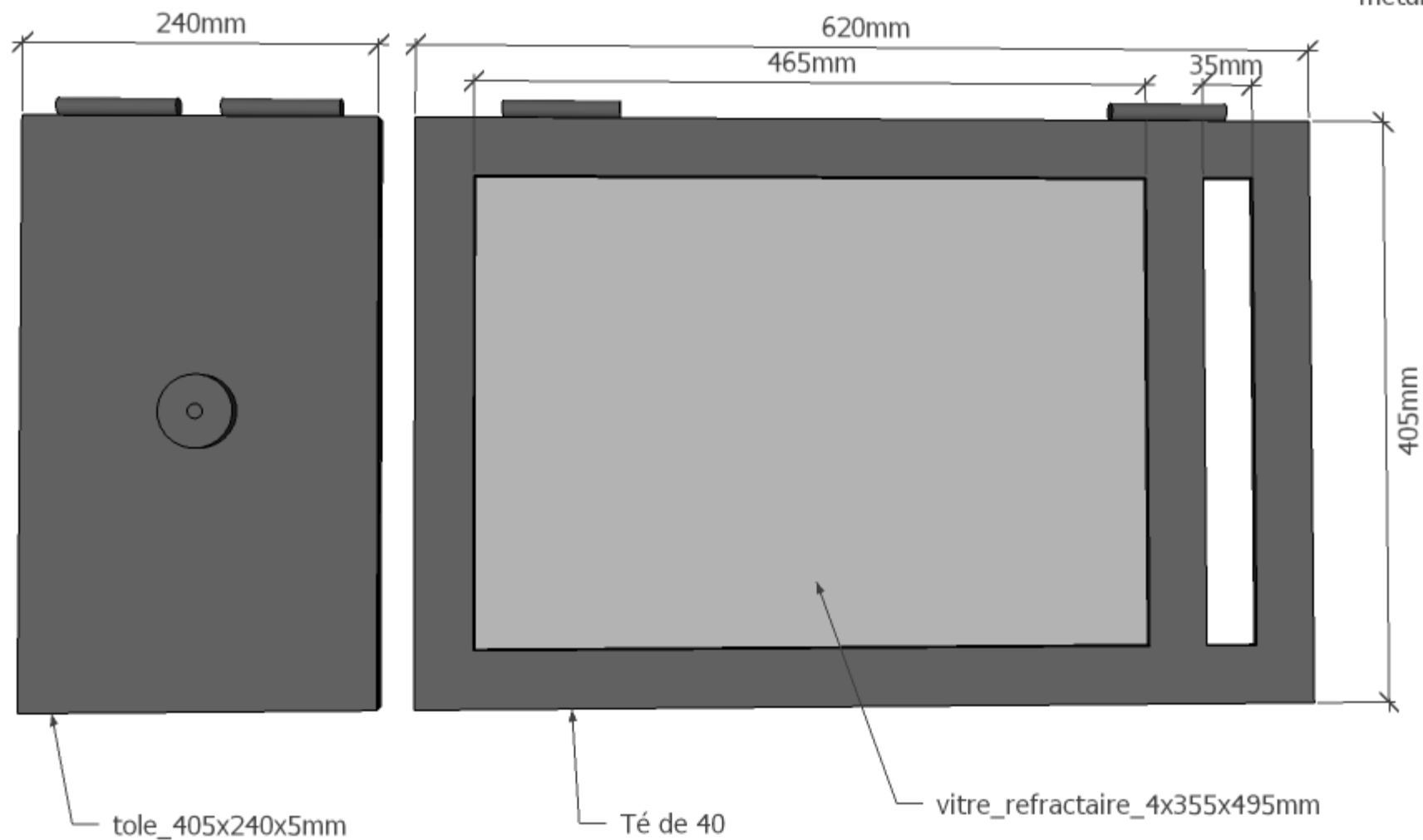

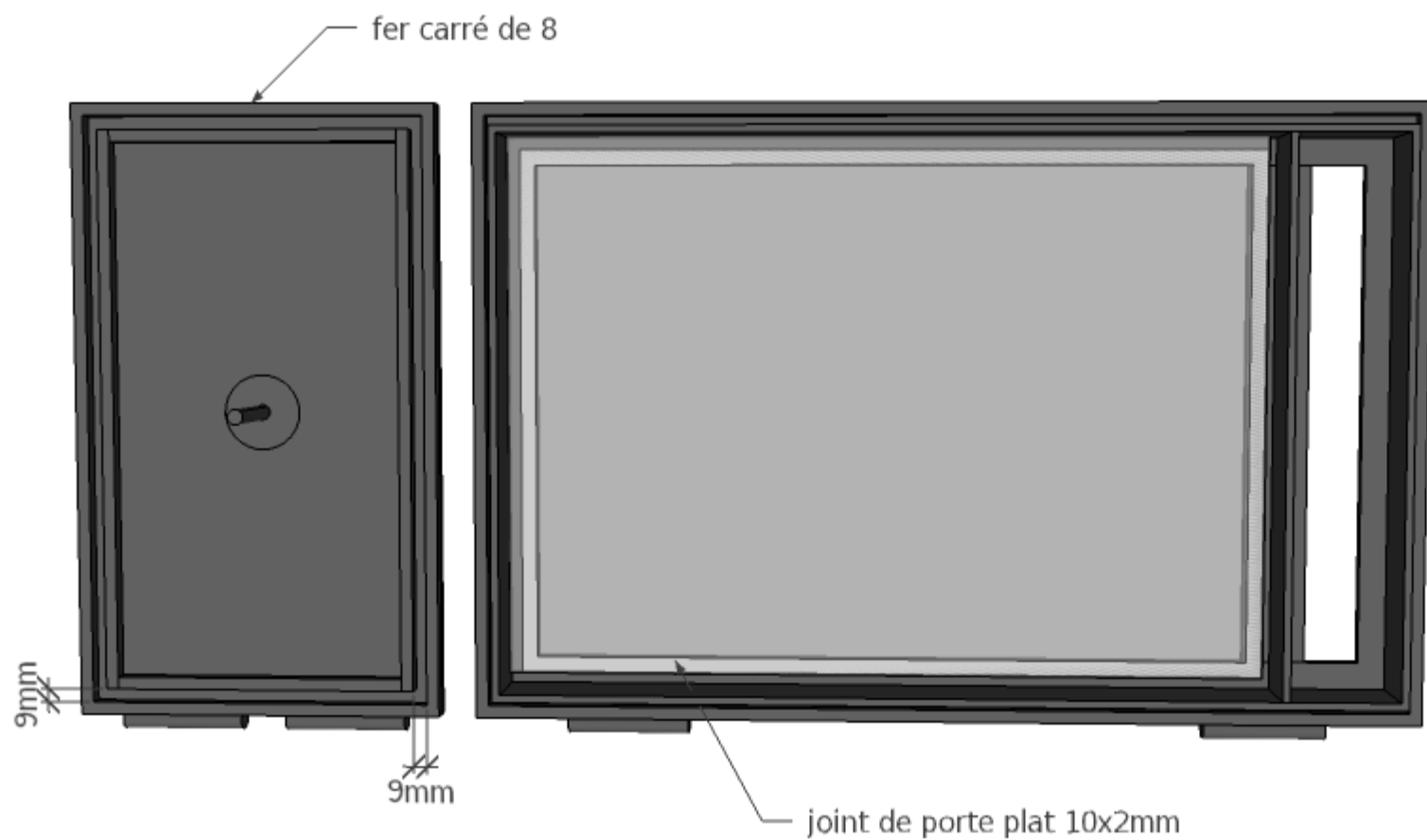

B28_inverse
metal_10

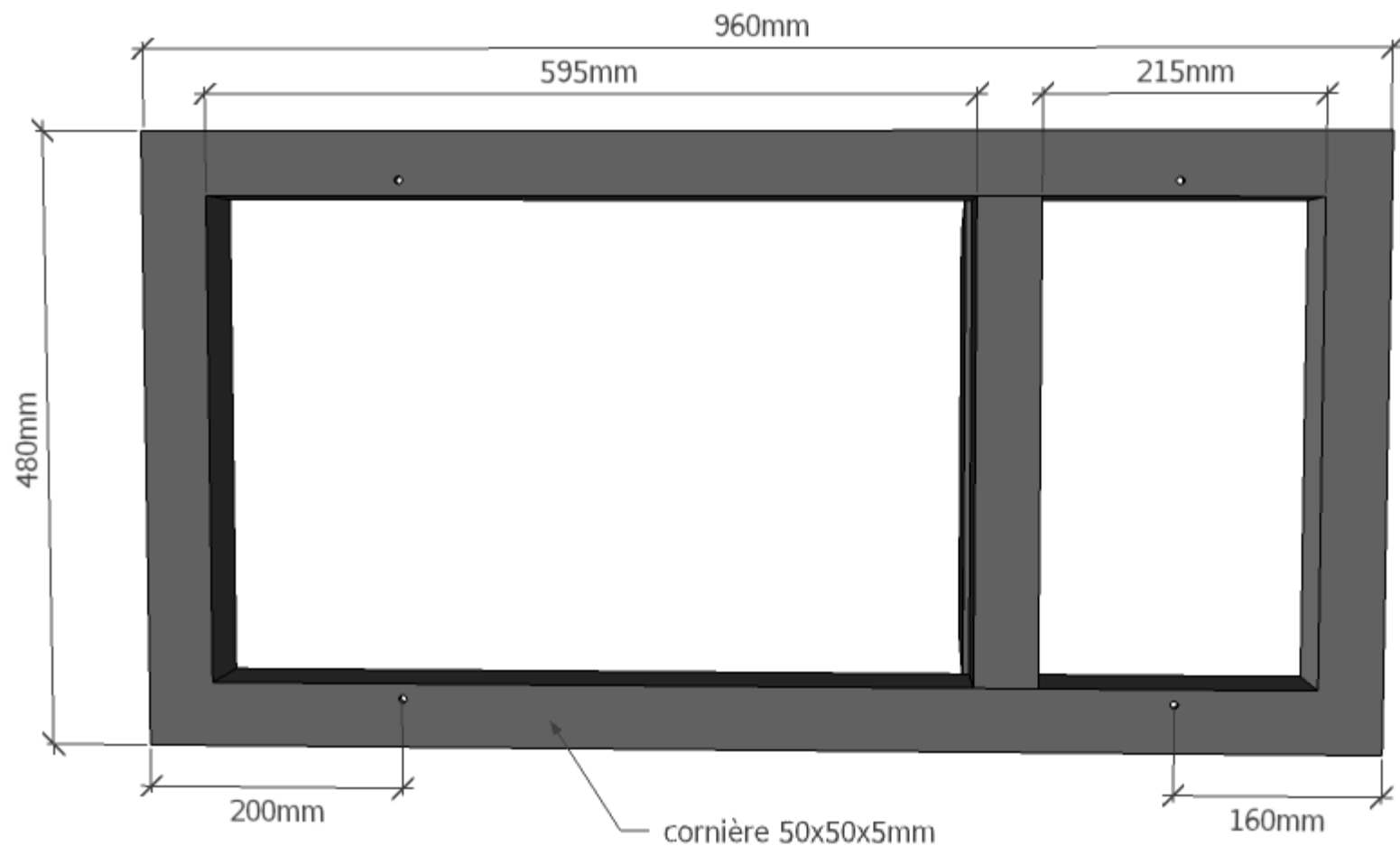

B28_inverse
metal_11

fer_plat_380x50x5mm

cornière_50x50x5x390_chanfreins

cornière_50x50x5x380mm

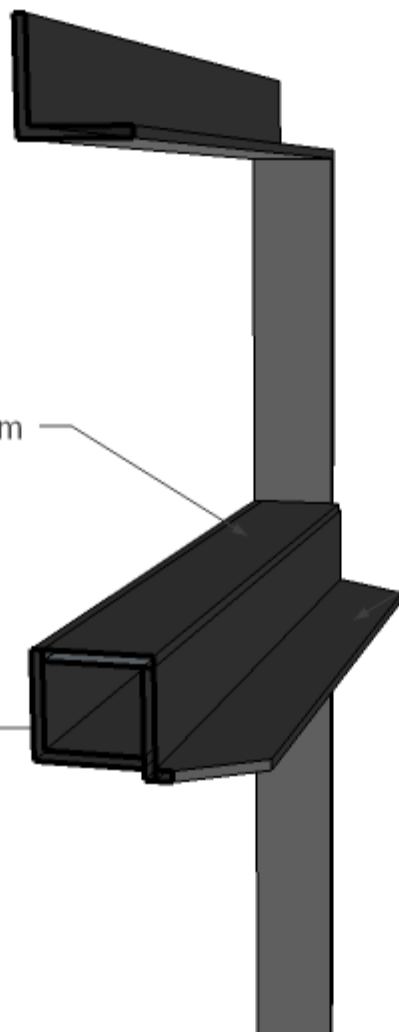

B28_inverse
metal_12

fer_plat_380x50x5mm

cornière_50x50x5x390_chanfreins de 30mm

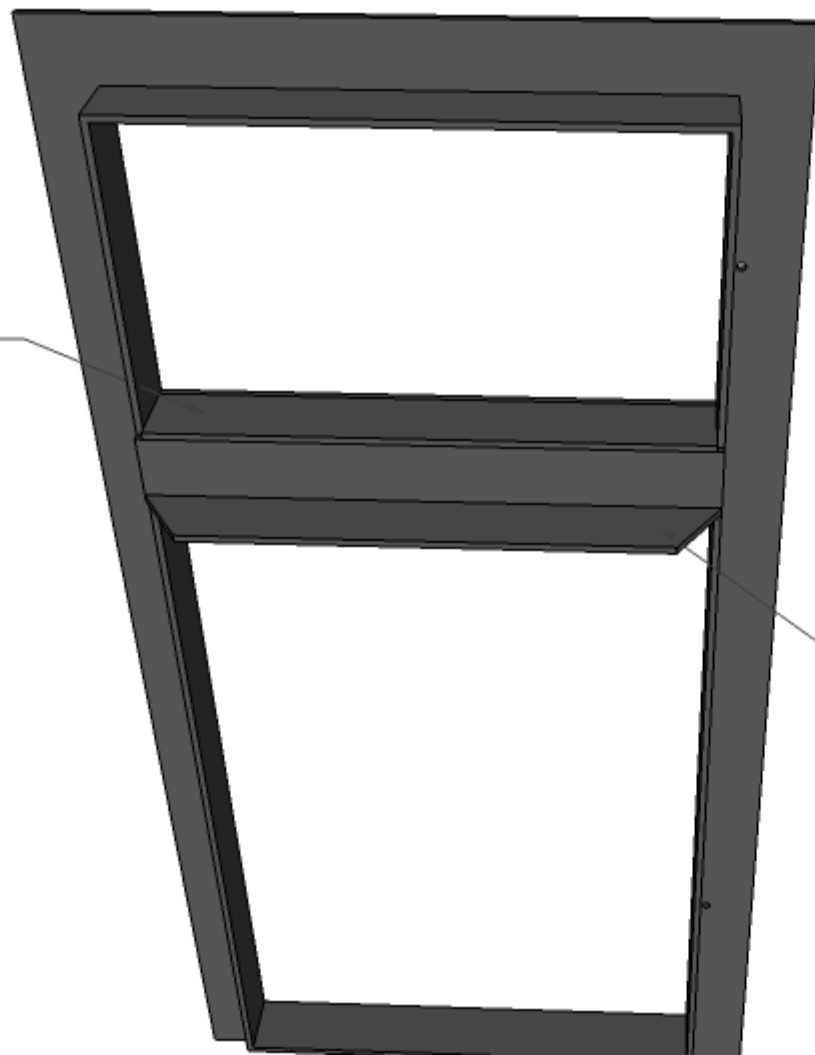

B28_inverse
metal_13

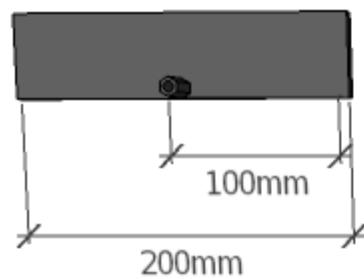

fer_plat_200x50x5mm



raccord_tige_filetee_M6



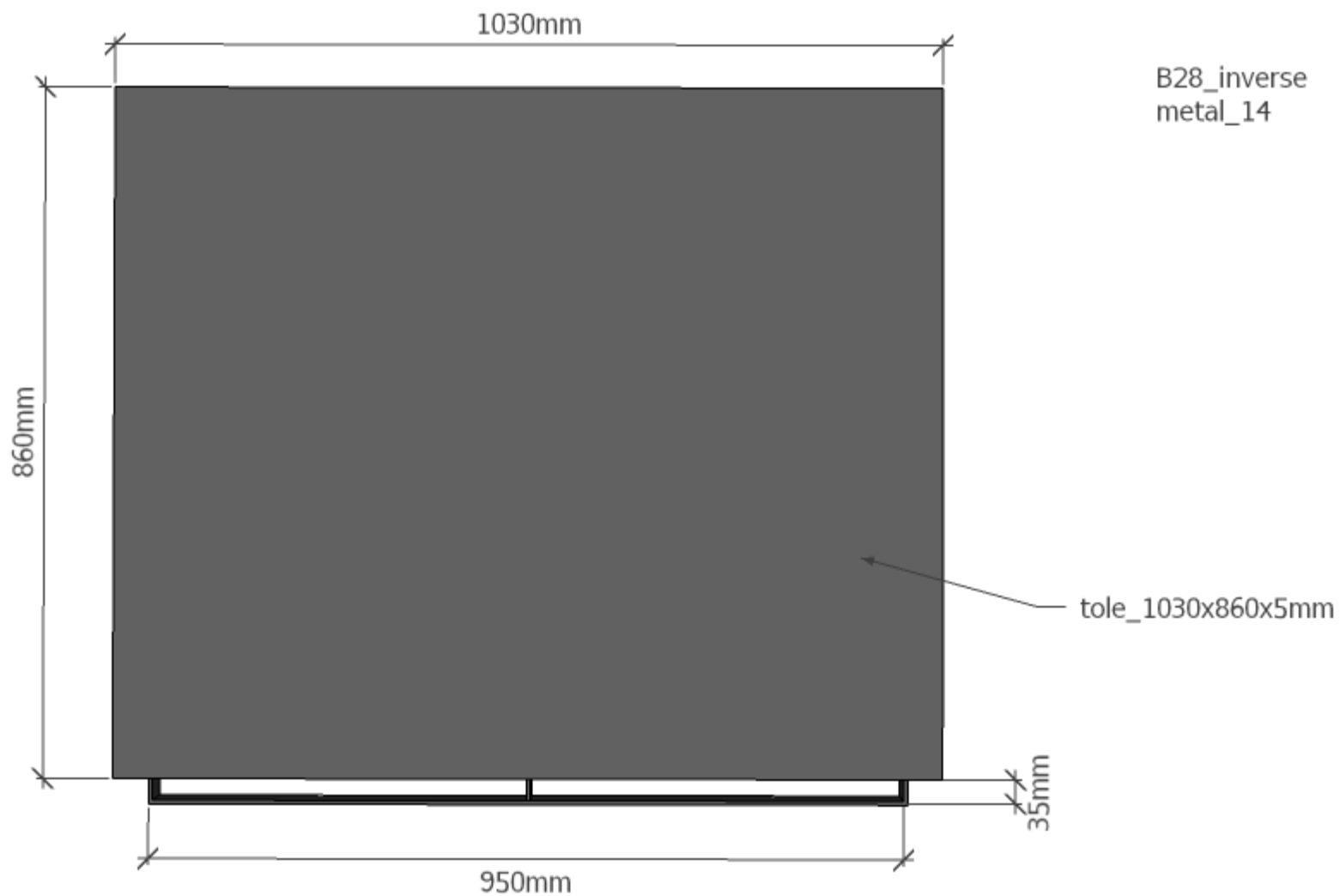

B28_inverse
metal_15

barre_de_protection_30x5mm

fer_plat_50x5x850

fer_plat_50x5x1030

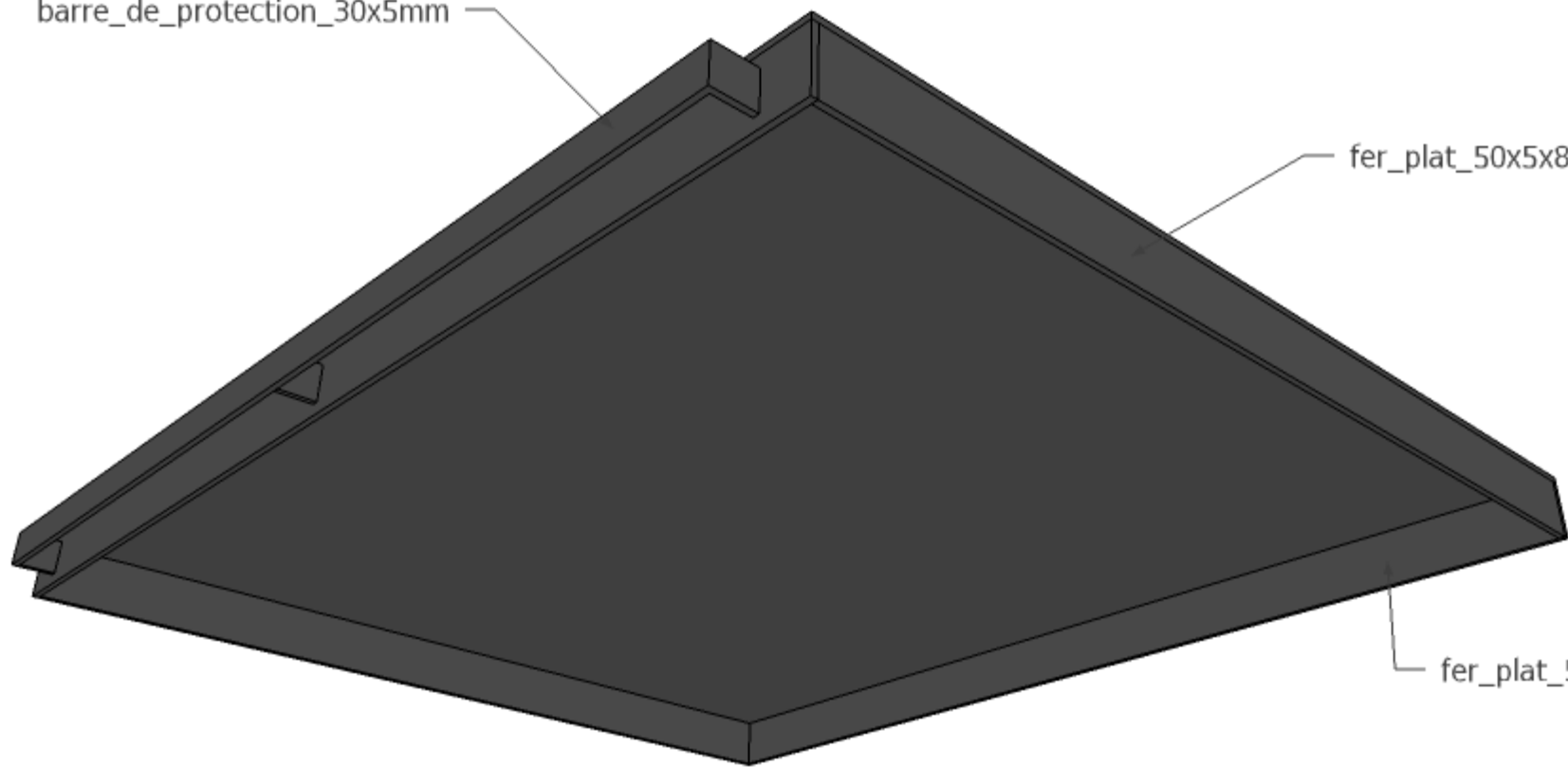

joint_plat_autocollant_10x2_trappe_visite

B28_inverse
metal_16

tole_150x150x5mm_percee

vis_8x100mm

fer_plat_50x5x200mm_taraudé_8mm

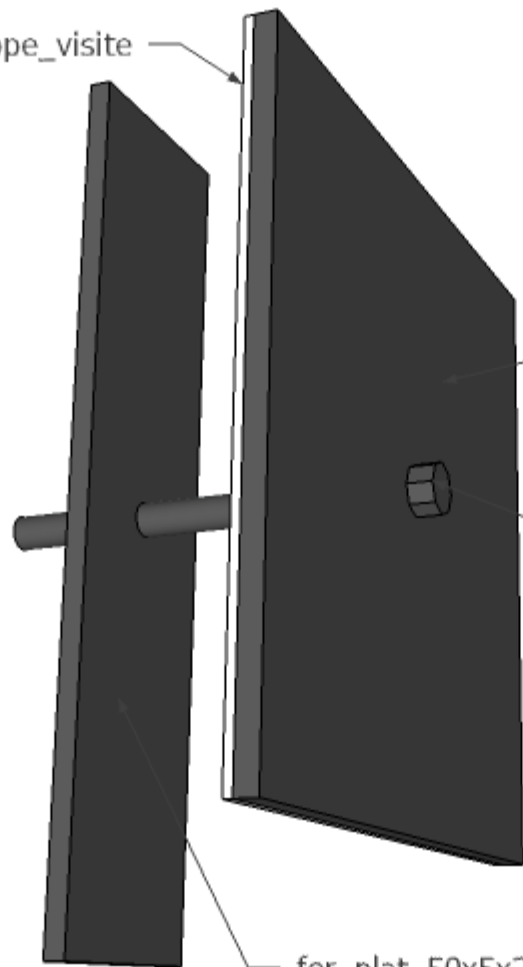

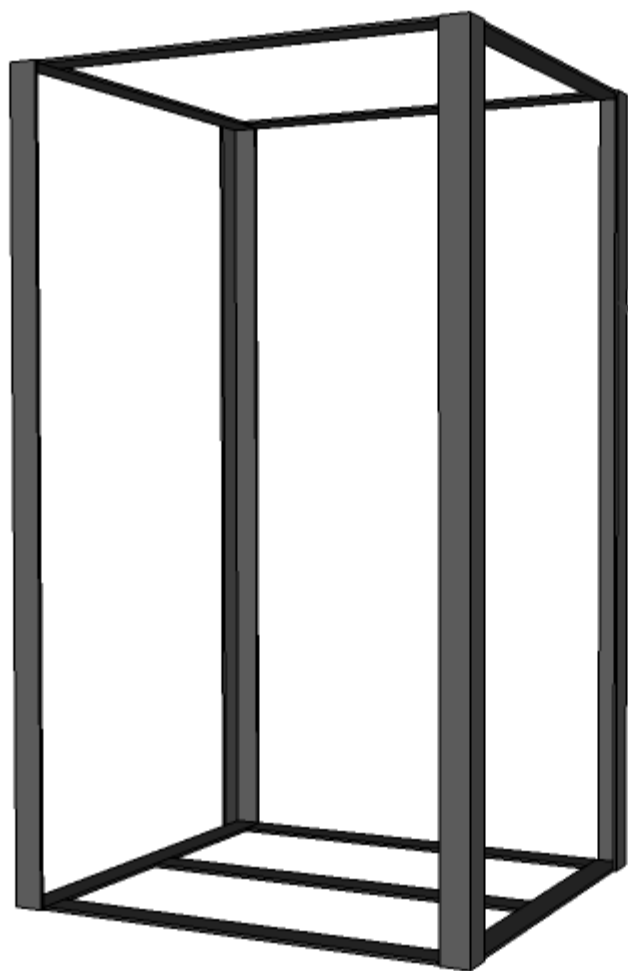

B28_inverse
metal_17

corniere_50x5mm_1380mm

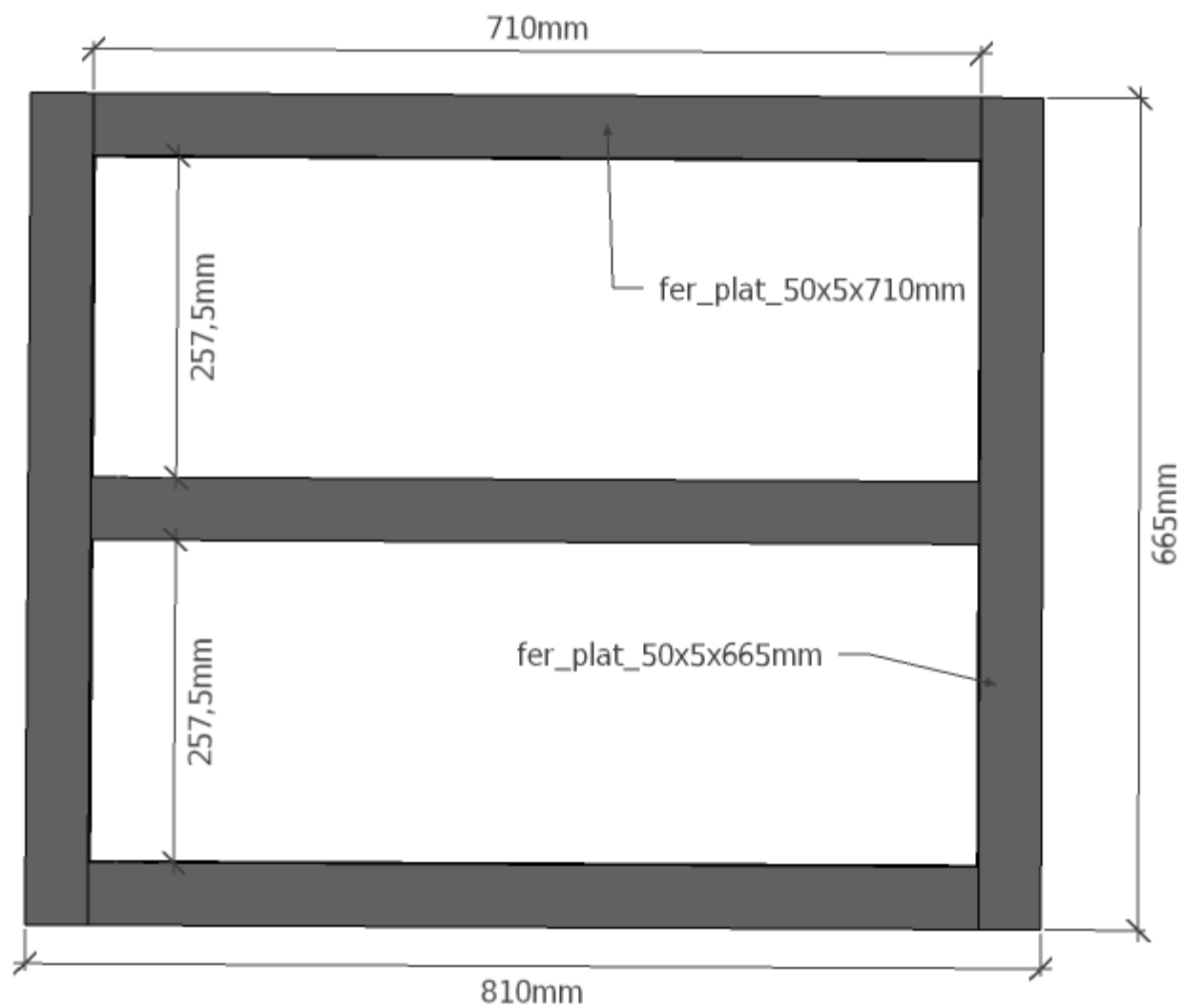

B28_inverse
metal_18

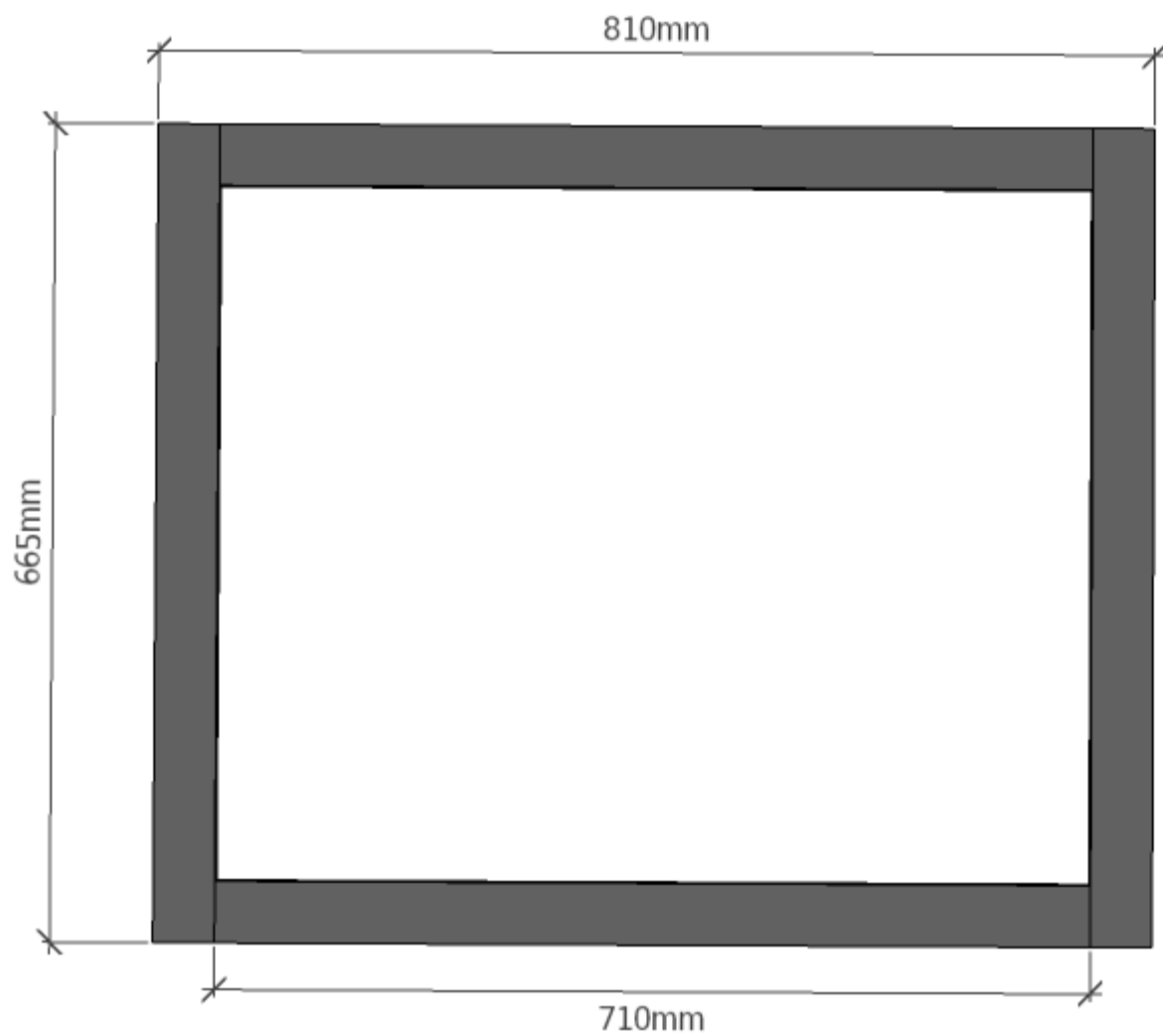

B28_inverse
metal_19